

APPLICATIONS

Foundation walls, inside insulation

Insulating the basement walls on the inside facilitates the completion of the basement by combining insulation with the pouring of the foundation walls.

The insulating panels form a thermal barrier in a perfect contact with the concrete. Moreover, the plastic ties inside the panels ensure the integrity of the final components by providing a rigid surface for the screwing of the drywall.

USE

Concrete formwork insulating panels are used as foundation insulation in new buildings, also used as concrete wall insulation.

DIMENSIONS

Insulating panels are 4" thick and are available in varying heights and widths of 2" to 24" for a perfect match with any form.



3 Great Plains Industrial Drive
Emerald Park Sk S4L 1C6
phone: 306.757.9433
mandoconstruction@sasktel.net
www.mandoconstruction.ca



SPECIALIZING IN
all concrete work basements,
grade beams, floors, etc.

INTRODUCING
patent pending

FORMFOAM
— SEE IT. BELIEVE IT. GET A QUOTE! —

**EXPANDED POLYSTYRENE
INSULATING PANEL
FOR CONCRETE FORMWORK
BASEMENTS**

Proud to be a part of the



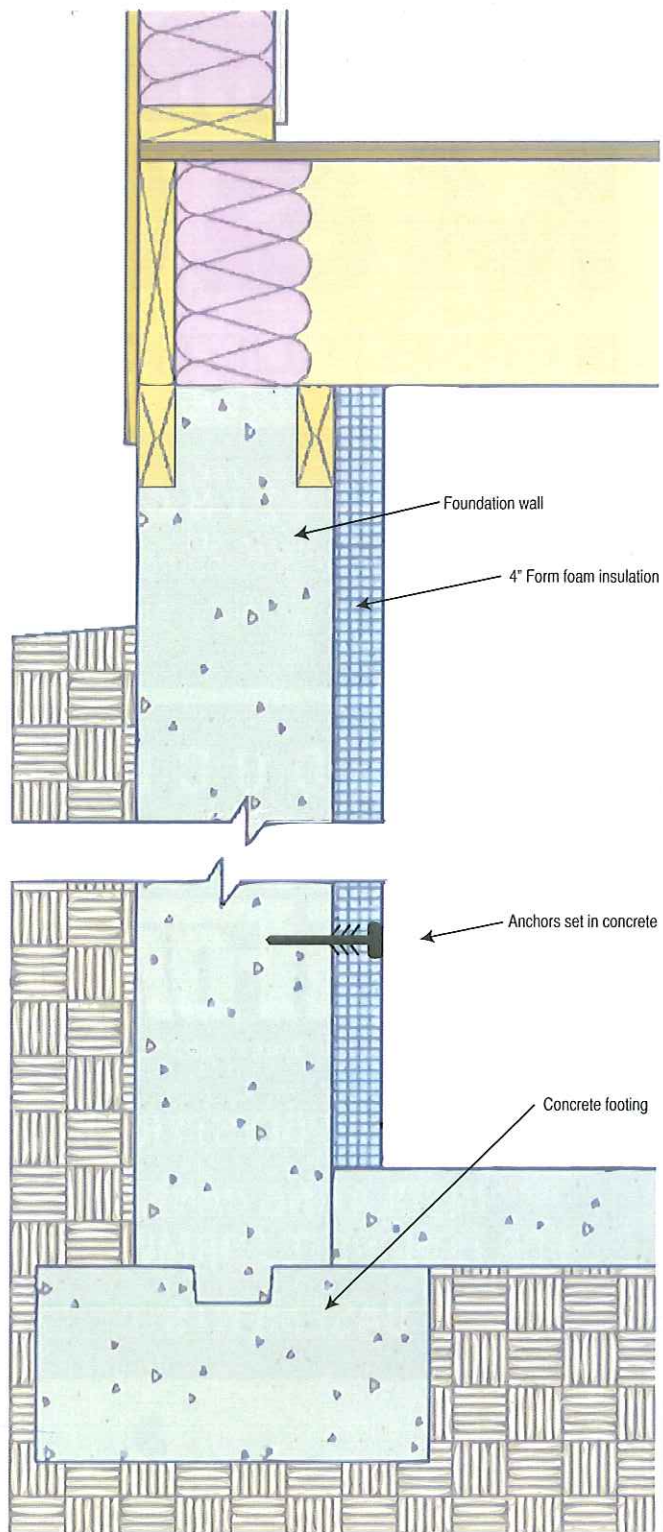

ADVANTAGES

Guarantees the ability to address defects in the concrete like rock pockets and holes that you cannot see with ICF.

Mold control

No air space between the concrete and insulation where warm moist air could infiltrate, condense and grow mold.

Odour control

It is not conducive to bacterial growth

Dry and comfortable space

No inside condensation

Improvement of air quality

No harmful gas emissions

DESCRIPTION

Concrete formwork insulating panels are made of rigid and closed plastic cells which ensure an optimal thermal performance and an excellent water resistance.

Placed in the formwork before the casting of the concrete, the panels ensure dryness, without unpleasant molds and odors. The elimination of the airspace between the concrete and insulation prevents warm moist air from infiltrating, condensing and creating mold.

Higher energy efficiency

Energy savings of up to 1/3 of the cost of heating and air conditioning

Stability

No ozone layer depleting substances

Strength

Composed of solid and anchored plastic ties through the formwork and provides a solid substract to anchor finishing

Quickness

Combines casting concrete and insulation into a single step

Durability

Preserves its insulating properties for life

PHYSICAL PROPERTIES

Property	4"
Thermal Resistance, min (R factor for 8" concrete, insulation, gypsum)	17.79
Dimensional Stability, max (%)	2.0
Flexural Strength, min (PSI)	40.0
Water Absorption, max (% by volume)	3.0
Compressive Resistance, min (PSI, at Yeild or 10% Deformation)	15.0
iOxygen Index, min (%)	24.0
8' Wall	5 Anchors per every 2'
9' Wall	6 Anchors per every 2'